

# UPPER LEVEL (Rooms 207-251)

## 8:00 AM Sunday School

C224 - F<sup>2</sup> Forever Followers (Paul and Amy Riggings)

## 9:30 AM Sunday School

B267 - Walkers  
 B264 - Toddlers  
 B262 - Two Year Olds  
 B258 - Three Year Olds  
 B251 - Pre-K

C223 - Adult 7 Department/  
 Classroom  
 C224 - Adult 6 Department/  
 Classroom  
 C233 - Adult 8 Department/  
 Classroom  
 C232 - Adult 8 Classroom  
 C231 - Special Ministries  
 C230 - Adult 7 Classroom  
 C229 - Adult 7 Classroom  
 C228 - Adult 6 Classroom  
 C227 - Adult 6 Classroom  
 C226 - Adult 6 Classroom

D207 - 8th Grade Girls  
 D209 - 11th Grade Girls  
 D217a - 9th Grade Girls  
 D217b - 9th Grade Boys

D208 - College Department

## 11:00 AM Sunday School

B267 - Walkers  
 B264 - Toddlers  
 B262 - Two Year Olds  
 B258 - Three Year Olds  
 B251 - Pre-K

C224 - F<sup>2</sup> Forever Followers (Paul and Amy Riggings)

D217a/b - Youth Department  
 D208 - "Encore" (Young Singles 18-29, Chris Jones)

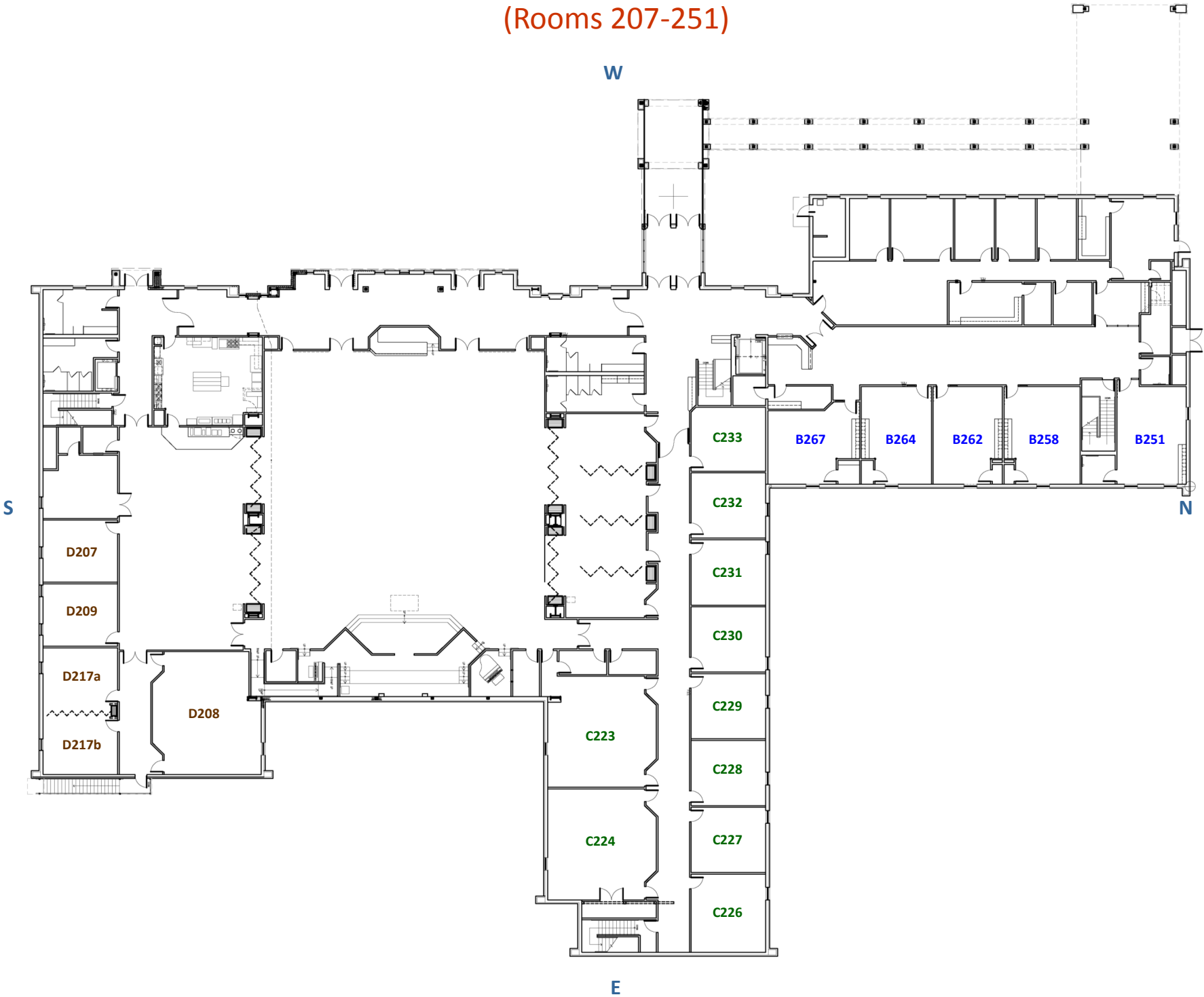

**9:30 AM Sunday School**

- B145 - 2nd Grade
- B146 - 1st Grade
- B147 - Kindergarten
- B152 - Babies
- B153 - Crawlers
- B154 - 3rd Grade
- B156 - 4th Grade
- B157 & 158 - 5th Grade

- D114a - 6th Grade Boys
- D114 - 8th Grade Boys
- D115 - 10th Grade Girls
- D117a - 7th Grade Boys
- D117 - Youth Large Group Room
- D118 - 6th & 7th Grade Girls
- D119 - 12th Grade Boys and Girls
- D120 - 10th & 11th Grade Boys
- D121 - 6th Grade Girls

- C123 - Family Enrichment
- C127 - "Life Journey" Older Singles
- C128 - Adult 5 Department
- C129 & 130 - Adult 4 Department
- C131 - "Life Quest" Young Adults
- C138 & 139 - Adult 4 Classrooms
- C140 & 141 - Adult 5 Classrooms
- C142 - Adult 2 & 3 Classroom
- C143 - Adult 2 & 3 Department

**11:00 AM Sunday School**

- B145 - 4th & 5th Grades
- B146 - 2nd & 3rd Grades
- B147 - Kindergarten & 1st Grade
- B152 - Bed Babies
- B153 - Crawlers

- C128 - Married with Children  
(Kevin and Tina Hanna)
- C130 - Young Adults (Shawn and Amber Crawley)

D117 - "Propel" (College)



**LOWER LEVEL  
(Rooms 114-158)**

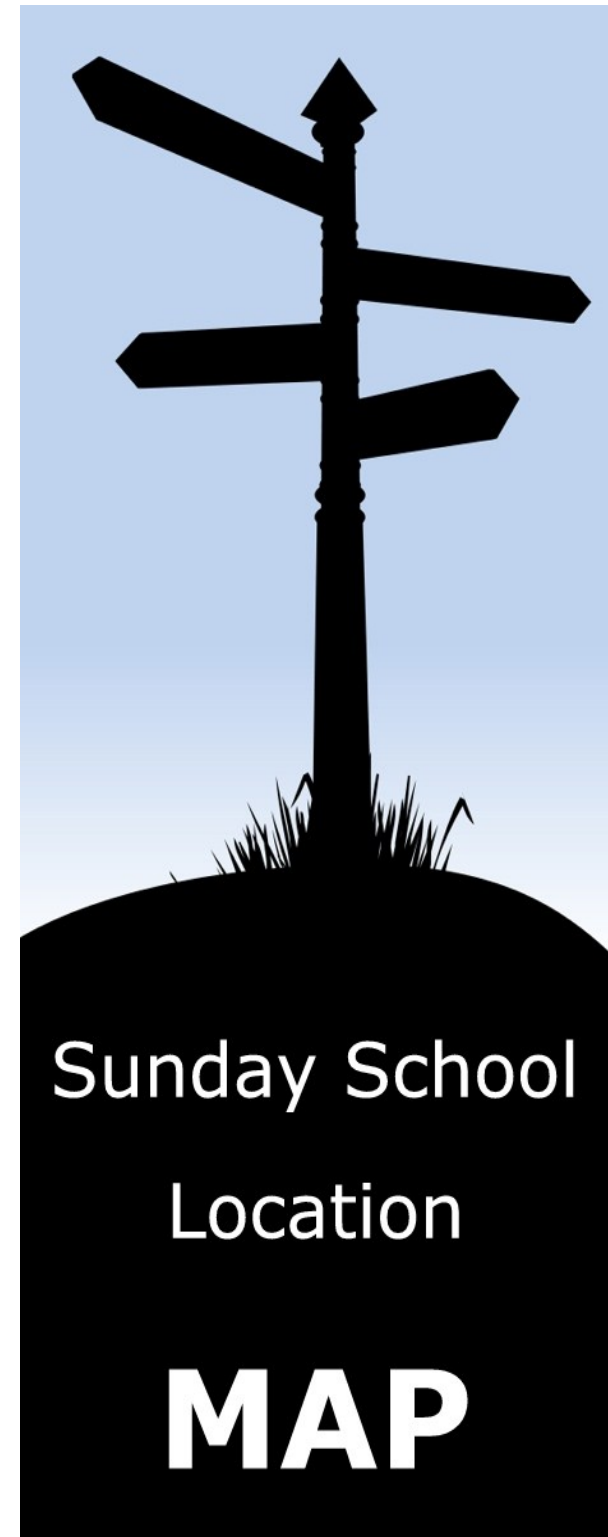

Sunday School  
Location  
**MAP**